

Model 1330 Double Banana Plug with Component Mounting Area

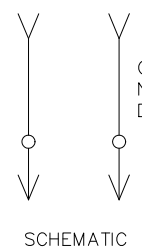
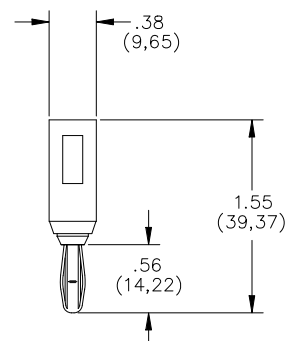
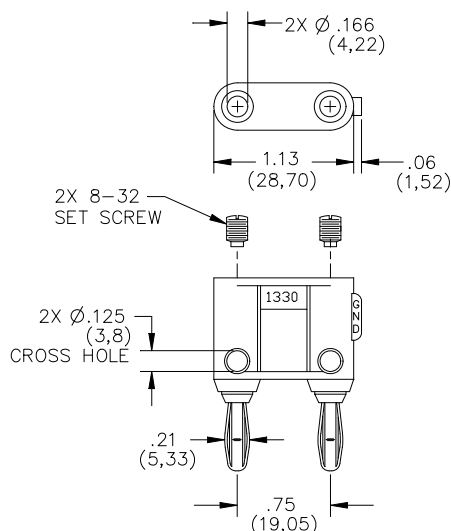

Model 1330
Double Banana Plug with
Component Mounting Area

Features

- Features a recessed area for mounting small discrete components with set screws.
- For test versatility, banana plugs can be vertically and horizontally stacked to the adapter.
- The banana plug features nickel plated beryllium copper for tarnish resistance & long insertion life.

Materials

Banana Plugs/Jacks:

Body: Brass, Nickel Plated
Spring: Beryllium Copper, Nickel Plated

Insulation:

Material: Polypropylene molded to Banana Jack and Banana Plug bodies.

Marking: "1330, POMONA ELECTRONICS CO., INC, POMONA CALIFORNIA"

Set Screws: #8-32 Single Slot, Steel, Zinc Plated

Specifications

Operating Voltage:

Hands free usage in controlled voltage environments: 5000 Vrms maximum.

For CE compliance: not intended for hand-held use at voltages above 33 Vrms/70 Vdc.

Operating Temperature: +50°C (+122°F) Max.

Current: 15 Amperes

Ordering Information

Model: 1330-*

*=Color, Standard Colors: -0 (Black), -2 (Red)

Ordering Example: 1330-2 (Color is Red)